

K-Containment[®] Seal: Polyurethane & Ceramic Composite Options

Lightweight, Durable Inner Seal

The critical component in any conveyor transfer point is an effective sealing system. The seal should be located where the material is being loaded and continue to where it becomes stable.

This is the last position to practically control spillage and dust. To enhance the success of the outer seal or skirting, the loading area should be properly supported.

K-Containment[®] Seal is a high performance, low friction engineered polyurethane system offering exceptional resistance to wear. The slotted arrangement allows for installation adjustment, ensuring that material cannot be entrapped leading to premature belt damage. In many cases the outer flexible seal is ineffective in controlling spillage as an unsupported belt trying to contain the full weight of material load would be inadequate.

Instead, to effectively contain bulk material the lightweight **K-Containment[®] Seal** should be installed inside the chute to handle high internal chute pressure and therefore reduce the load on the skirting seal. The steel-backed polyurethane seal can be supplied bevelled or straight edged.

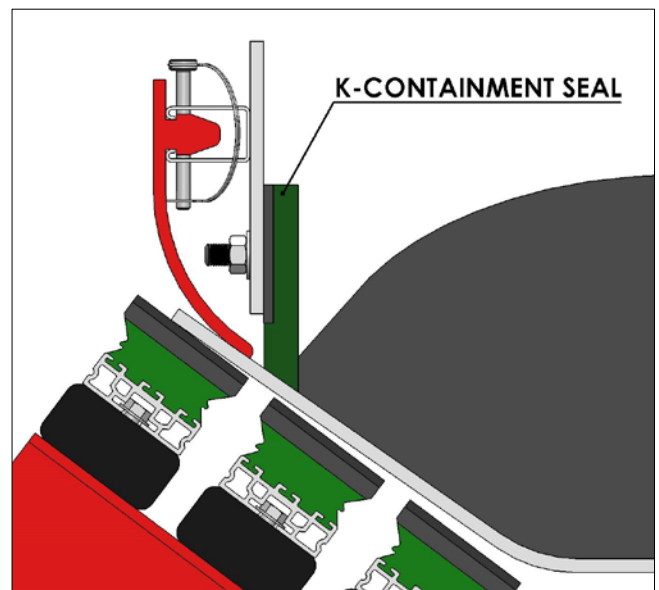

<https://kinder.com.au>

Subject to © Kinder Australia Pty Ltd
Issue: 202101

Kinder Australia Pty Ltd

26 Canterbury Road, Braeside VIC 3195
PO Box 1026, Braeside VIC 3195

☎ +61 3 8587 9111
☎ +61 3 8587 9101

✉ conveyorsolutions@kinder.com.au
ABN: 28 006 489 238

K-Containment® Seal: Polyurethane & Ceramic Composite Options

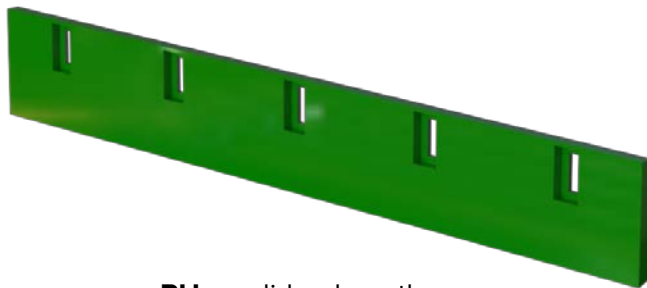

PU – solid polyurethane

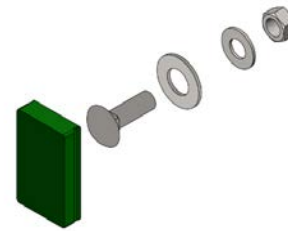

Snap Plug Kit Assembly G83

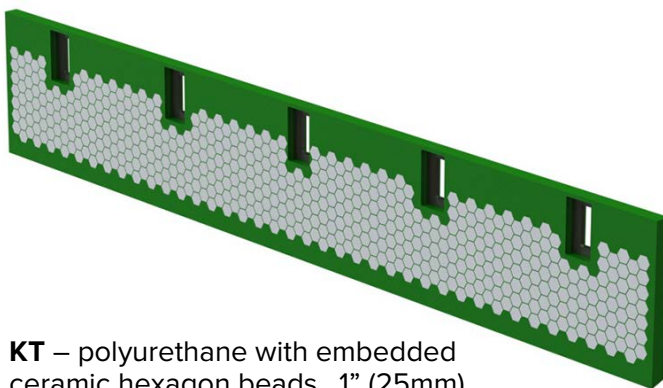

KT – polyurethane with embedded ceramic hexagon beads. 1” (25mm) thick only. Various height and length. Used for sliding abrasion.

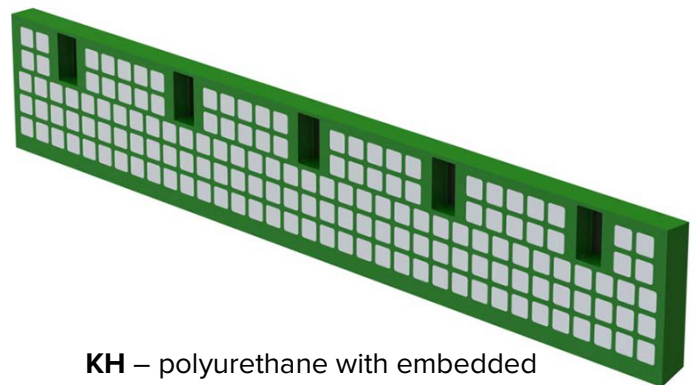

KH – polyurethane with embedded ceramic cube beads. 2” (50mm) thick only. Various height and length. Used for high impact and sliding abrasion.

Type	Description	Kinder Part Number	Dimensions Thickness (mm)	Dimensions Height x Length (mm)	Centre Slot Pitch	Bevel
PU	Solid PU / Steel Backed	K-FAW-CP-CL-L6602-G83	25	152 x 1524	305	20°
		K-FAW-CP-CL-L8602-G83		203 x 1524		
		K-FAW-CP-CL-T6602-G83		152 x 1524		
		K-FAW-CP-CL-T8602-G83	50	203 x 1524	533	
		K-FAW-CP-CL-L8962-G83		203 x 2438		
		K-FAW-CP-CL-L10962-G83		254 x 2438		
		K-FAW-CP-CL-L12962-G83	25	304 x 2438		
		K-FAW-CP-CL-T8962-G83		203 x 2438		
		K-FAW-CP-CL-T10962-G83		254 x 2438		
K-FAW-CP-CL-T12962-G83	50	304 x 2438				
KH	Polyurethane / Ceramic Cube Beads / Steel Backed	Contact Kinder for part number	50	Various		
KT	Polyurethane / Ceramic Hexagon Beads / Steel Backed	Contact Kinder for part number	25	Various		



Kinder Australia Pty Ltd

26 Canterbury Road, Braeside VIC 3195
PO Box 1026, Braeside VIC 3195

☎ +61 3 8587 9111
✉ +61 3 8587 9101

✉ conveyorsolutions@kinder.com.au

ABN: 28 006 489 238

<https://kinder.com.au>

Subject to © Kinder Australia Pty Ltd

Issue: 202101